

# Controllable check valve

## Type 2294

### Controllable check valve with compression joint

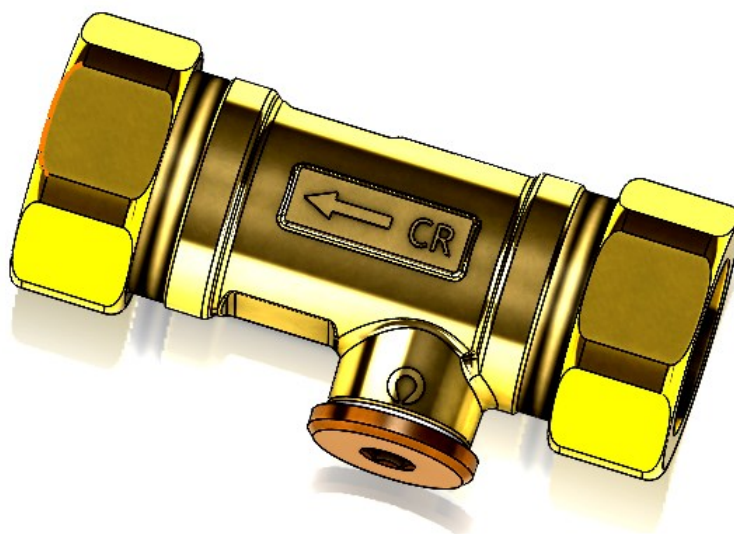

#### Application:

Compression joints can be used in all installations with pex or copper pipes.

Installing of type 2294 prevent backflow, for medium category 2 according to EN 1717 specification.

Compression joints in both ends causes no other fittings to be required in the installation.

Installed where backflow preventer is required in new as well as existing water installations. Strong construction with an easy available bronze plug.

Available in sizes 12 to 28 mm.

#### Product Description:

Body made of CW625N.

Union nut made of CW602N.

Compression joints made of CW602N

Plug machined in CC499K.

Material are approved according to 4MS UBA list 8th Revision 01.12.2017.

Check valve cartridge.

#### Certificates/Test:

GDV approved, cert. 03/00112.

SITAC TG approved: 5089/93

Tested according to NKB9 and EN/DS 13959.

100 % quality check of each valve.

Yearly audit test, carried out by Danish Technological Institute.



 61 Inspected by DTI

#### Technical Data:

Low opening pressure.

Max temperature 90° C

Working pressure 10 bar (tested at 16 bar).

# Controllable check valve

## Type 2294

### Controllable check valve with compression joint

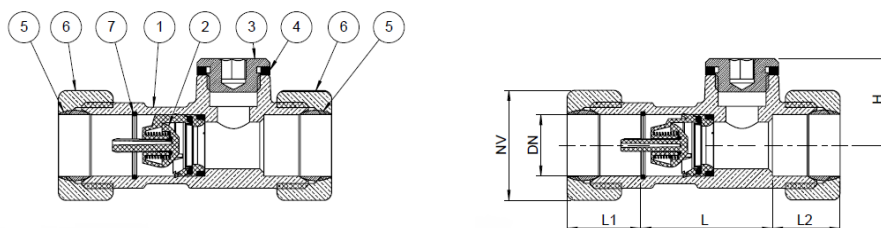

Component	Material	Component	Material
1. Body	CW625N	2. Check valve cartridge	POM
3. Plug	CC499K	4. Gasket	PTFE
5. Compression ring	CW602N	6. Union nut	CW602N
7. Spring ring	Stainless steel		

Purchase no.	LNS no.	DN mm	Cartridge	H mm	L mm	L1 mm	L2 mm	NV mm	Estimated Weight kg
2294-012	347-012-10-00	12	15	21	45	20	20	20	0,16
2294-015	347-015-10-00	15	15	21	33	18	17	24	0,17
2294-018	347-018-10-00	18	15	24	28	23	23	27	0,17
2294-022	347-022-10-00	22	20	26	33	25	25	31	0,23
2294-028	347-028-10-00	28	25	30	37	25	25	38	0,32

